



# RANGE OVERVIEW





THE SUNSEEKER RANGE SETS NEW STANDARDS AND  
BENCHMARKS FOR LUXURY PERFORMANCE MOTOR  
YACHTS. FROM THE MAJESTIC YACHT AND SUPERYACHT  
RANGES THROUGH TO THE TIMELESS PERFORMANCE,  
PREDATOR, SPORT YACHT AND MANHATTAN SERIES  
AND OUR VERY LATEST OCEAN RANGE, EACH  
SUNSEEKER IS THE PURSUIT OF PERFECTION.

CONTENTS

HERITAGE.....	4
INNOVATION.....	6
CRAFTMANSHIP.....	7
AWARDS AND ACHIEVEMENTS .....	8
<b>PERFORMANCE</b>	
HAWK 38 .....	11
SUPERHAWK 55.....	21
<b>PREDATOR</b>	
PREDATOR 55.....	32
PREDATOR 65.....	45
PREDATOR 75.....	57
<b>SPORT YACHT</b>	
55 SPORT YACHT.....	70
65 SPORT YACHT .....	82
75 SPORT YACHT .....	95
<b>MANHATTAN</b>	
MANHATTAN 55 .....	108
MANHATTAN 68.....	120
<b>YACHT</b>	
76 YACHT.....	133
88 YACHT .....	145
95 YACHT.....	157
100 YACHT .....	169
<b>OCEAN</b>	
OCEAN 156.....	182
90 OCEAN.....	199
OCEAN 182 .....	211
OCEAN 460.....	224
<b>SUPERYACHT</b>	
116 YACHT.....	235
120 YACHT .....	247
131 YACHT.....	260



## HERITAGE

Sunseeker is the world's leading brand for luxury performance motor yachts. Originally named Poole Power Boats, the company was founded by brothers Robert and John Braithwaite in 1969. The company changed its name to Sunseeker International in 1985 and has since become a global icon, with every Sunseeker the result of an uncompromising and unmatched approach to design, craftsmanship and performance.



SOVEREIGN 20



## HERITAGE

We have continued to develop and perfect our yachts. Technical and design excellence have always been fundamental to the very fabric of our being.



SUPERHAWK 34



105 YACHT



A man wearing a white polo shirt and a VR headset is holding two VR controllers. He is standing in front of a large, detailed architectural drawing of a yacht hull, which is projected onto a wall. The drawing shows the complex lines and structure of the yacht's hull, including the cockpit area and the hull's curvature. The man is looking down at the controllers, and the VR headset is covering his eyes. The overall scene suggests a virtual reality environment used for yacht design and visualization.

## INNOVATION

Our Centre of Excellence for Design and Technology is a central hub that vertically integrates each conceptual, design and build phase of our yachts. We are proud to lead the industry in technical innovation and smart design solutions.





## CRAFTMANSHIP

We have over 50 years of boat building experience. As the first significant yacht manufacturer in Britain, our rich heritage is fundamental to our brand identity. The quality of our craft, the product we produce and the services we provide. Our boats are built by hand and we take great pride in our production facilities and in-house capability. Many thousands of hours go into perfecting our craft and this commitment makes a Sunseeker unique.





# AWARDS AND ACHIEVEMENTS

## 2024

### MOTOR BOAT AWARDS

*Superhawk 55 – Sportscruisers over 45ft*

## 2023

### WORLD YACHT TROPHIES

*Superhawk 55 - Best Exterior Design*

### WORLD YACHT TROPHIES

*Ocean 182 - Best Layout*

### MOTOR BOAT AWARDS

*90 Ocean – Best Custom Yacht*

## 2022

### THE ENGAGE MARKETING AWARDS

*Best Use of Innovation in Customer Engagement*

### METSTRADE BOAT BUILDER AWARDS

*Best Apprenticeship and Training Scheme*

### WORLD YACHT TROPHIES

*100 Yacht – Best Exterior Design*

### MOTOR BOAT AWARDS

*65 Sport Yacht – Sports Cruisers over 45ft*

### BOAT DESIGN & INNOVATION AWARDS

*90 Ocean Sunseeker X-TEND™ – Innovation of the Year*

### ROBB REPORT BEST OF THE BEST AWARDS

*65 Sport Yacht SkyHelm™*

## 2021

### WORLD YACHT TROPHIES 2021

*65 Sport Yacht – Best Exterior Design, 64' – 80'*

*88 Yacht – Best Exterior Design, 80' – 98'*

*90 Ocean – Best layout, 80' – 98'*

### IBI BOAT BUILDER AWARDS

*65 Sport Yacht SkyHelm™ – Innovative On-Board Design Solution*

## 2020

### MOTOR BOAT AWARDS

*76 Yacht – 'Flybridges over 60ft'*

## 2019

### MOTOR BOAT AWARDS

*Predator 50 – 'Best Sports cruiser over 45ft'*

### ASIA BOATING AWARDS

*74 Sport Yacht – 'Best Sports Cruiser – above 55 Feet'*

### CHRISTOFLE YACHT STYLE AWARDS

*74 Sport Yacht – Best Motor Yacht in Asia, 20-25m*

## 2018

### CHRISTOFLE YACHT STYLE AWARDS

*76 Yacht – Best International Motor Yacht 15-24m*

### MOTOR BOAT OF THE YEAR AWARDS

*Manhattan 66 – Best Flybridge Over 60ft*

### ASIA BOATING AWARDS

*Predator 50 – Best Sports Cruiser up to 55ft*

## 2017

### MOTOR BOAT OF THE YEAR AWARDS

*Manhattan 52 – Best Flybridge up to 55ft*

### ASIA PACIFIC BOATING AWARDS

*131 Yacht – Best Yacht Design*

### BOAT BUILDER AWARDS

*Sunseeker 'BEACH CLUB' concept*

*– Most Innovative On-Board Design Solution*

### BOAT BUILDER AWARDS

*Best Apprenticeship and Training Scheme*

## 2016

### MOTOR BOAT OF THE YEAR AWARDS

*Predator 57 – Sports Cruiser over 45ft*

### ASIA BOATING AWARDS

*155 Yacht – Best Production Motor Yacht*

### WALPOLE AWARDS

*Champion of British Luxury Manufacturing*

### BOAT BUILDER AWARDS

*Robert Braithwaite – Lifetime Achievement Award*

## 2015

### ASIA BOATING AWARDS

*Best Brand Presence*

## 2014

### WORLD YACHT TROPHIES

*101 Sport Yacht – 'Best Exterior Design'*

### ASIA BOATING AWARDS

*Predator 80 – Best Worldwide Production*

*Motor Yacht 15M-24M*

### WORLD SUPERYACHT AWARDS

*40 Metre Yacht 'Sea Raider V' – Finalist*

## 2013

### ASIA BOATING AWARDS

*Best Brand Presence*

### MOTOR BOAT OF THE YEAR AWARDS

*28 Metre Yacht – 'Best Custom Yacht'*

## 2012

### MOTOR BOAT OF THE YEAR AWARDS

*Manhattan 63 – 'Best Flybridge above 55ft'*

### ROBB REPORT CHINA

*'Best of the Best' 28 Metre Yacht*

### ASIA BOATING AWARDS

*28 Metre Yacht – Best Production*

*Motor Yacht 24M-40M*

### WORLD SUPERYACHT AWARDS

*Predator 130 'Never Say Never' – Finalist*

## 2011

### ASIA BOAT AWARDS

*Best Brand Presence in Asia*

### EUROPEAN CEO CORPORATE LIFESTYLE AWARDS

*Best Luxury Brand*

### SHOWBOATS DESIGN AWARDS FLORIDA

*Naval Architecture Motoryacht 'Evil Zana'*

*Predator 130*

## 2010

### WORLD SUPERYACHT AWARDS

*Predator 130 'Evil Zana' – Finalist*

### QUINTESENTIALLY AWARDS

*Yacht Charter of the Year*

### SYDNEY BOAT SHOW

*Boating Industry Association of NSW*

*– Best Marina Display*

### SYDNEY BOAT SHOW

*Boating Industry Association of NSW*

*– Best Overall Display*

### ASIA BOATING AWARDS

*Predator 60 – Best Production Motoryacht 51 to 80 feet*



# AWARDS AND ACHIEVEMENTS

2009

**SYDNEY BOAT SHOW**

*Display of Excellence*

**CROATIA BOAT SHOW**

*Predator 92 Sport – Best in Class*

**CROATIA BOAT SHOW**

*30 Metre Yacht – Best in Class*

**CROATIA BOAT SHOW**

*Best Boat Show Stand*

2008

**MOTOR BOAT OF THE YEAR AWARDS**

*Manhattan 60*

2007

**EUROPEAN POWERBOAT OF THE YEAR**

*Superhawk 43*

**ASIA PACIFIC BOATING AWARDS**

*90 Yacht, Best of the Best*

**MODERN BOATING MAGAZINE**

*Portofino 47, Imported Powerboat of the Year*

**AUSTRALIAN MARINE INDUSTRIES  
FEDERATION AWARDS**

*Predator 62, Imported Powerboat of the Year*

**NOMINATED BY THE SUPERYACHT SOCIETY**

*37 Metre Yacht 'The Snapper'*

**QUEEN'S AWARD FOR ENTERPRISE**

*International Trade*

**ROBERT BRAITHWAITE IS HONOURED WITH CBE**

*The Queen's Birthday Honours List*

2006

**NOMINATED FOR THREE SUPERYACHT AWARDS**

*Predator 108 'SHIVER'*

2005

**AUSTRALIAN MARINE INDUSTRIES  
FEDERATION AWARDS**

*75 Yacht, Non-Trailable Boat Award*

**AUSTRALIAN MARINE INDUSTRIES  
FEDERATION AWARDS**

*Portofino 46, Commendation*

**MODERN BOATING,  
POWER BOAT OF THE YEAR AWARDS**

*Predator 68, Imported Powerboat of the Year*

**BOATS.COM MARINE INDUSTRY WEB AWARDS**

*Manufacturers Category for www.sunseeker.com*

2004

**SYDNEY BOAT SHOW**

*Best Overall Display*

**SYDNEY BOAT SHOW**

*Best Marina Display*

2003

**AUSTRALIAN MARINE AWARDS**

*Manhattan 56, Award for Excellence*

**AUSTRALIAN MARINE AWARDS**

*Predator 68, Best Imported Non-Trailable Yacht*

2002

**ENTREPRENEUR OF THE YEAR AWARD**

*Robert Braithwaite MBE*

2001

**BEST POWER DESIGN AWARD**

*105 Yacht, The Superyacht Society*

**BEST POWER INTERIOR AWARD**

*105 Yacht, The Superyacht Society*

**PRESIDENT'S AWARD**

*Southern California Marine Association*

2000

**QUEEN'S AWARD FOR ENTERPRISE**

*Continuous Innovation and Development*

**THE TIMES EXPORTER OF THE YEAR**

*Times Export Awards*

**ROBB REPORT AWARD**

*Best of the Best, Boating and Sailing*

1999

**ROBB REPORT AWARD**

*Best of the Best, Boating and Sailing*

**MOTORBOAT OF THE YEAR**

*Predator 75, BT British Nautical Awards*

1998

**SUPERYACHT DESIGN AWARD**

*Manhattan 74, Superyacht Design Awards*

**EDITOR IN CHIEF AWARDS**

*Yachts Magazine*

1997

**LIFETIME ACHIEVEMENT AWARD**

*Robert Braithwaite MBE, RYA Awards*

1996

**MOTORCRUISER OF THE YEAR AWARD**

*RYA British Nautical Awards*

**EXPORTER OF THE YEAR AWARD**

*DCCI Export Awards*

1995

**BOAT BUILDER OF THE YEAR AWARD**

*RYA/BMIF British Nautical Awards*

1994

**QUEEN'S AWARD FOR EXPORT ACHIEVEMENT**

*Queen's Awards for Industry*

1992

**BEST IN THE WORLD AWARD**

*Renegade 60, Boating Magazine*

**ROBERT BRAITHWAITE IS HONOURED  
WITH MBE**

*The Queen's Birthday Honours List*

1990

**EXPORTER OF THE YEAR**

*SW International Business Awards*

1989

**QUEEN'S AWARD FOR EXPORT ACHIEVEMENT**

*Queen's Awards for Industry*

1987

**QUEEN'S AWARD FOR EXPORT ACHIEVEMENT**

*Queen's Awards for Industry*



A full-page background image of a powerful ocean wave. The wave is in the process of crashing, with a large, curling crest of white foam on the right side. The water is a deep, vibrant blue, and the overall scene conveys a sense of raw power and movement. The word "PERFORMANCE" is centered horizontally across the middle of the image, overlaid on the wave's face.

PERFORMANCE





HAWK 38





## H A W K 38

The Hawk 38 has the heart of a racer and a soul born of Sunseeker's performance roots: cutting-edge technology and incredible design. With twin Mercury 400R outboards paired to Mercury Racing Digital Zero Effort throttles, it delivers a thunderous 62 knots with safe, predictable handling and unparalleled agility.







## PRINCIPAL CHARACTERISTICS

LENGTH OVERALL  
11.85M / 38' 11"

BEAM  
3.01M / 9' 9"

DISPLACEMENT  
5,000 KG / 11,020 LB

FUEL CAPACITY  
700 LITRES / 185 US GAL.

FRESH WATER CAPACITY  
100 LITRES / 26 US GAL.

BLACK WATER CAPACITY  
70 LITRES / 18 US GAL.

ENGINE OPTIONS (TOTAL)  
2 X MERCURY UP TO 800HP

MAXIMUM SPEED  
UP TO 62 KNOTS

RANGE @ 21 KNOTS  
UP TO 200 NAUTICAL MILES

DRIVES  
OUTBOARDS



























## HAWK 38

### GENERAL ARRANGEMENTS

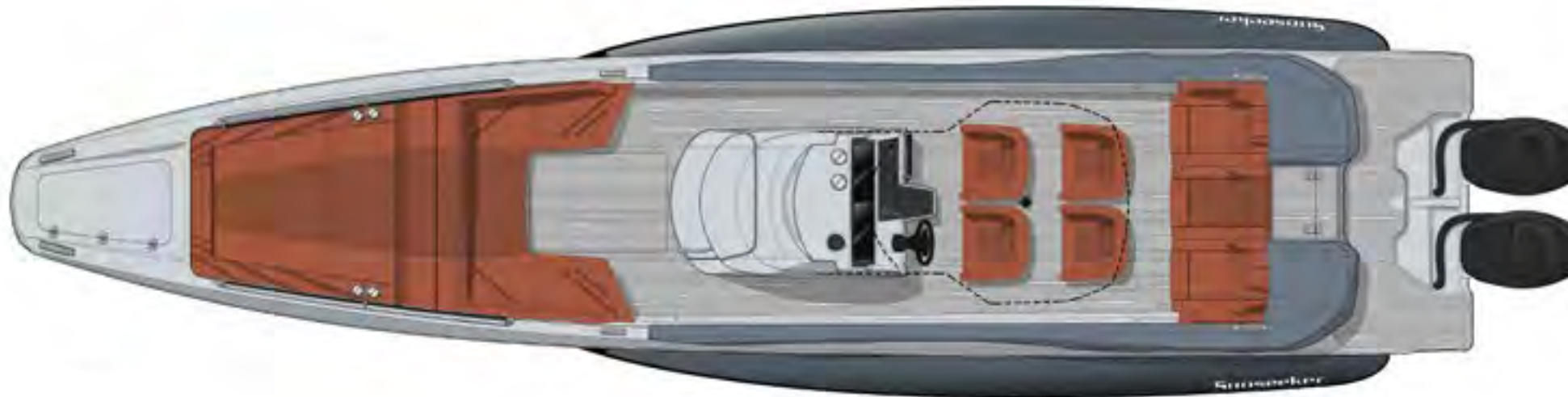

PROFILE AND EXTERIOR PLAN





S U P E R H A W K 5 5





## SUPERHAWK 55

The Superhawk 55 is an open day boat set to thrill with sleek design, exquisite detailing and exciting innovations. An incredibly lightweight performance yacht, she is powered by twin Volvo Penta D11 - IPS 950 engines, capable of a thrilling 38 knots with exceptional agility.







## PRINCIPAL CHARACTERISTICS

LENGTH OVERALL  
17.13M / 56' 2"

BEAM  
4.93M / 16' 2"

DRAFT  
1.43M / 4' 8"

DISPLACEMENT  
26,100 KG / 57,500 LB

FUEL CAPACITY  
1,800 LITRES / 476 US GAL.

FRESH WATER CAPACITY  
430 LITRES / 114 US GAL.

BLACK WATER CAPACITY  
150 LITRES / 39 US GAL.

ACCOMMODATION  
UP TO 4 GUESTS

ENGINE OPTIONS (TOTAL)  
VOLVO PENTA IPS UP TO 1,450PS

MAXIMUM SPEED  
UP TO 38 KNOTS

DRIVES  
PODS























# SUPERHAWK 55

## GENERAL ARRANGEMENTS

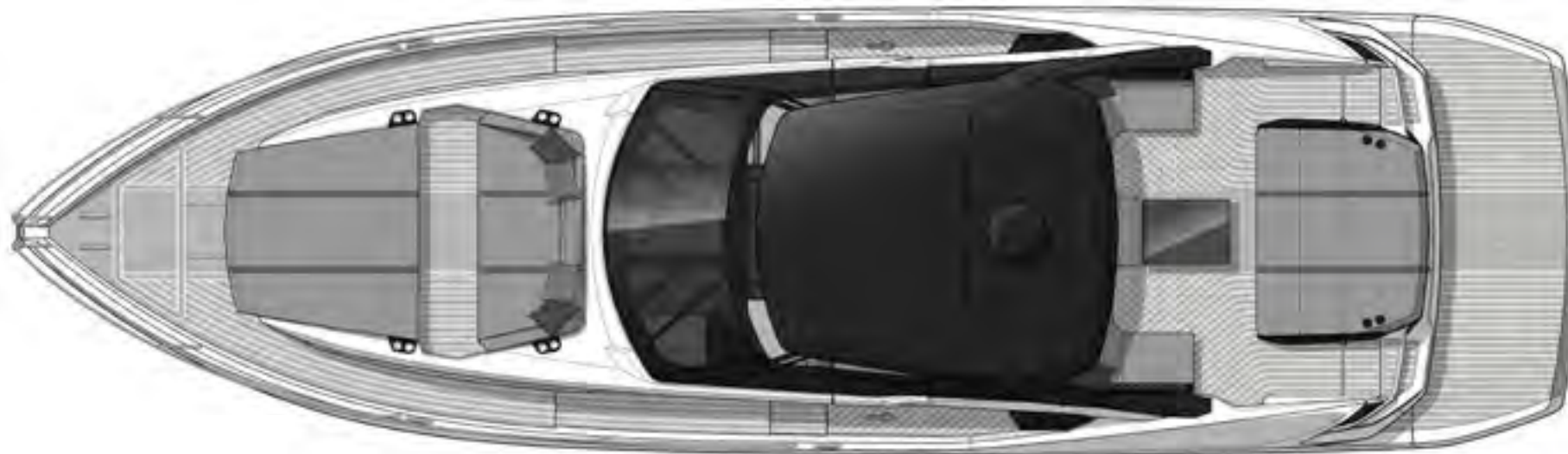

PROFILE AND EXTERIOR PLAN  
SHOWN WITH OPTIONAL SIDE DECKING



## SUPERHAWK 55 GENERAL ARRANGEMENTS



MAIN AND LOWER DECK  
SHOWN WITH OPTIONAL TENDER





PREDATOR





PREDATOR 55





## PREDATOR 55

Born to perform. Style and functionality work cohesively to define a yacht built for driving and enjoyment.







## PRINCIPAL CHARACTERISTICS

LENGTH OVERALL  
17.14M / 56' 3"

BEAM  
4.93M / 16' 2"

DRAFT  
1.48 M / 4' 10"

FUEL CAPACITY  
1,800 LITRES / 476 US GAL.

FRESH WATER CAPACITY  
430 LITRES / 114 US GAL.

BLACK WATER CAPACITY  
150 LITRES / 39 US GAL.

ACCOMMODATION  
UP TO 6 GUESTS

ENGINE OPTIONS (TOTAL)  
VOLVO PENTA IPS UP TO 1,450PS

MAXIMUM SPEED  
UP TO 36 KNOTS

DRIVES  
PODS



























# PREDATOR 55

## GENERAL ARRANGEMENTS

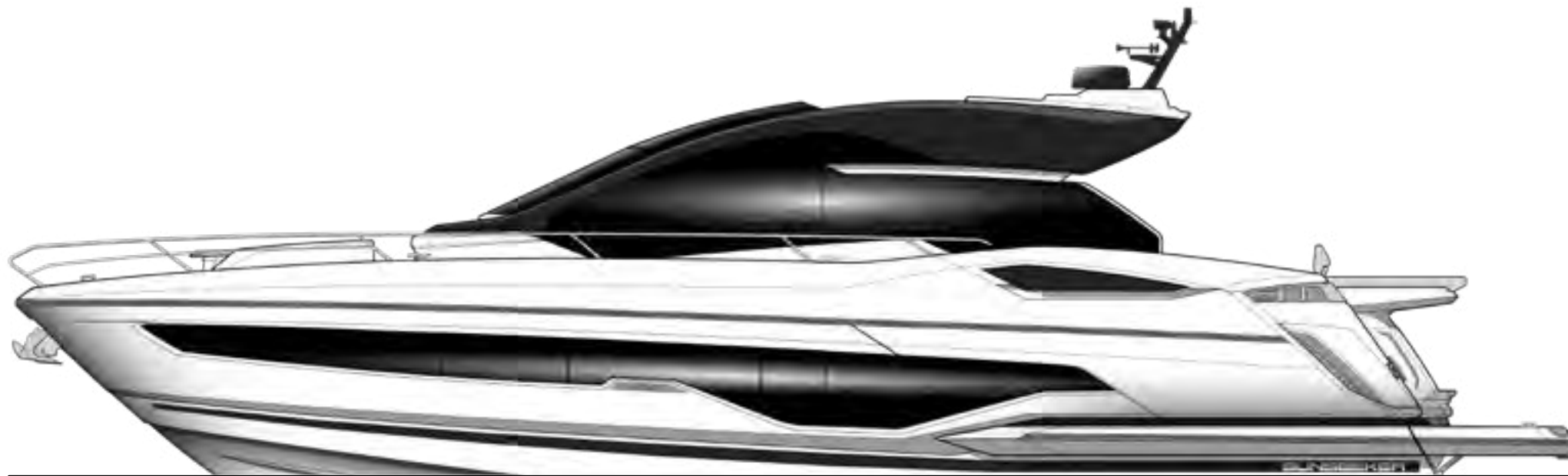

### PROFILE

SHOWN WITH OPTIONAL RADAR AND NAVIGATION EQUIPMENT



PREDATOR 55  
GENERAL ARRANGEMENTS

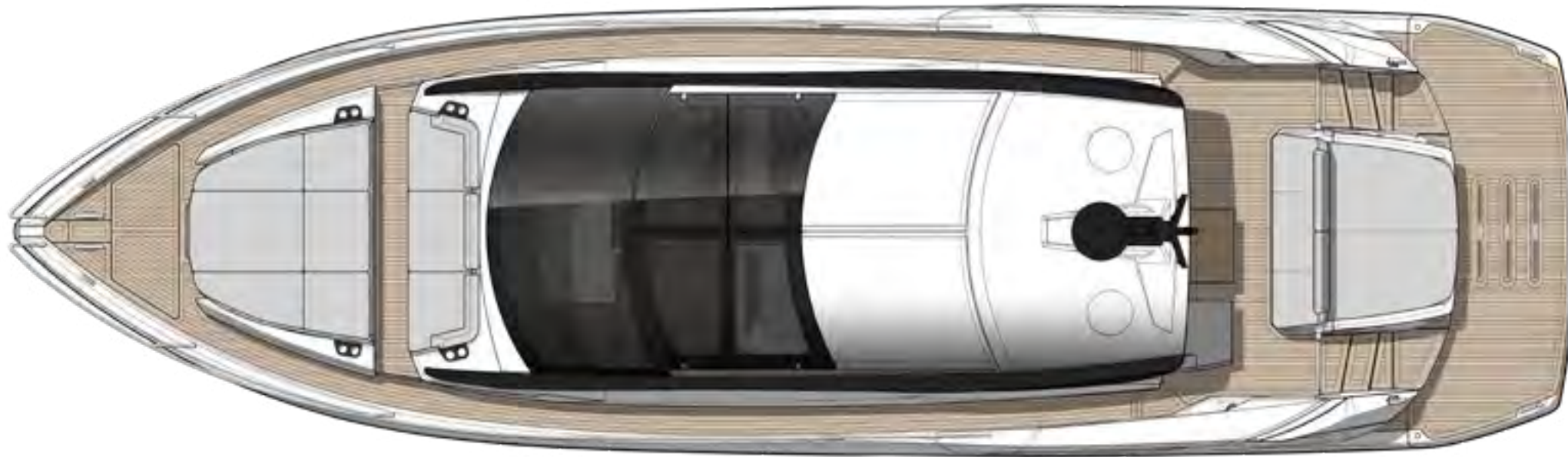

EXTERIOR PLAN  
SHOWN WITH OPTIONAL SIDE DECKING



## PREDATOR 55 GENERAL ARRANGEMENTS



MAIN DECK  
SHOWN WITH OPTIONAL SIDE DECKING



# PREDATOR 55

## GENERAL ARRANGEMENTS



OPTIONAL  
LAUNDRY ROOM



OPTIONAL STARBOARD  
TWIN GUEST CABIN



OPTIONAL MASTER  
STATEROOM  
BREAKFAST SEATING



### LOWER DECK

SHOWN WITH OPTIONAL ADDITIONAL APPLIANCE AND TENDER IN GARAGE





PREDATOR 65





## PREDATOR 65

Perfectly balancing traditional Sunseeker design concepts with cutting-edge innovation gives us the all-new Predator 65, a dynamic performance model with a purity of line that delivers an exhilarating driving experience with luxurious entertainment spaces to match.







## PRINCIPAL CHARACTERISTICS

LENGTH OVERALL  
20.50M / 67' 2"

BEAM  
5.10M / 16' 8"

DRAFT  
1.60 M / 5' 3"

DISPLACEMENT  
37,810 KG / 83,357 LB

FUEL CAPACITY  
3,500 LITRES / 924 US GAL.

FRESH WATER CAPACITY  
800 LITRES / 211 US GAL.

BLACK WATER CAPACITY  
200 LITRES / 52 US GAL.

ACCOMMODATION  
UP TO 7 GUESTS AND  
UP TO 1 CREW

ENGINE OPTIONS (TOTAL)  
VOLVO PENTA IPS UP TO 2,000PS

MAXIMUM SPEED  
UP TO 35 KNOTS

RANGE @ 10 KNOTS  
UP TO 750 NAUTICAL MILES

DRIVES  
PODS



























PREDATOR 65  
GENERAL ARRANGEMENTS

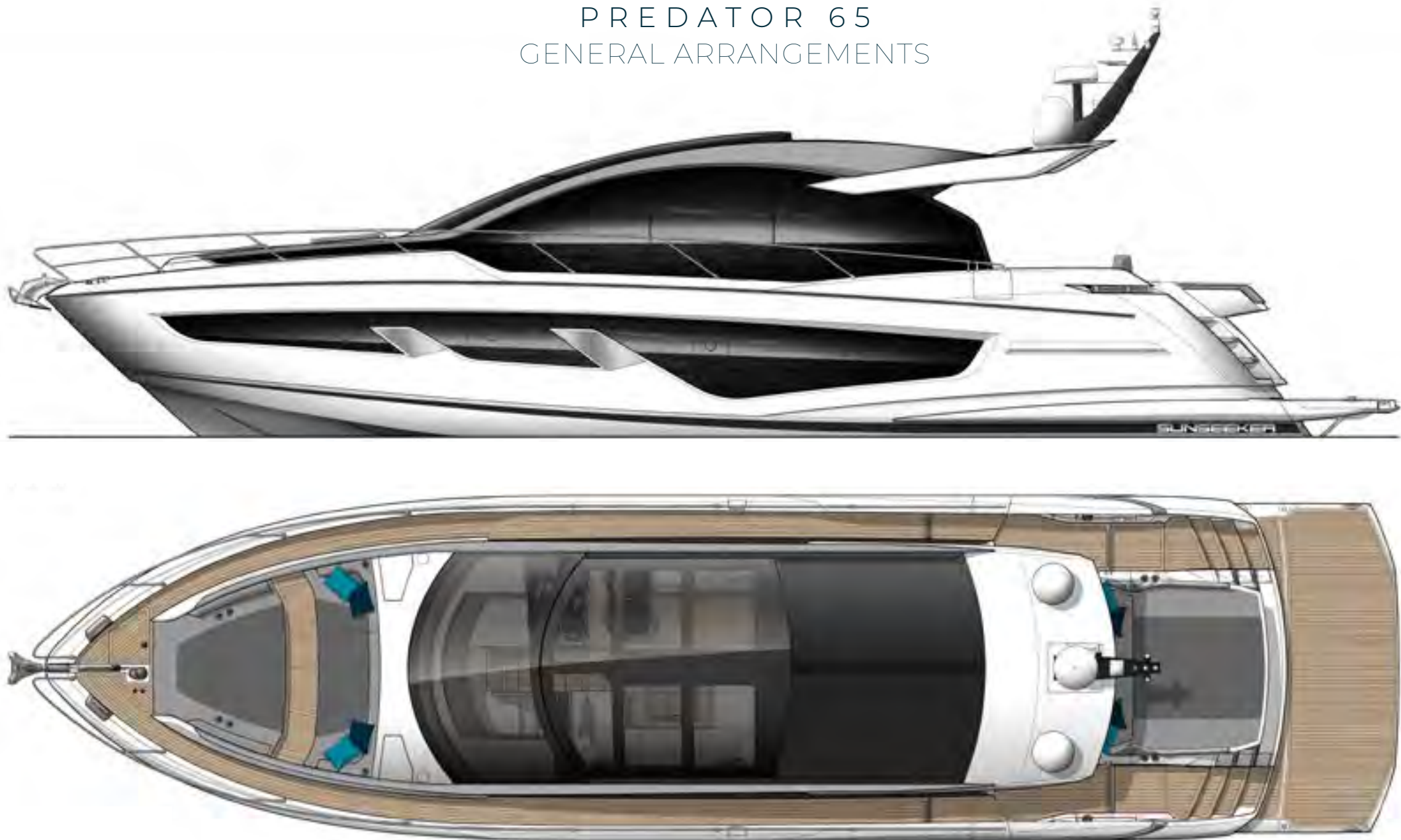

PROFILE AND EXTERIOR PLAN



# PREDATOR 65

## GENERAL ARRANGEMENTS

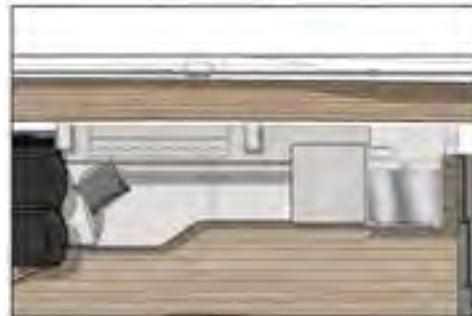

STARBOARD SIDE SOFA WITH RISE  
& FALL TV OUTBOARD.



EXTENDED PORT SIDE SEATING TO SUIT LOWER  
DECK GALLEY ARRANGEMENT.



PORT SIDE COCKPIT WETBAR.



EXTENDED COCKPIT SEATING ARRANGEMENT.

### MAIN DECK AND OPTIONS



## PREDATOR 65 GENERAL ARRANGEMENTS



EXTENDED MASTER STATEROOM WITH OFFICE AREA



LOWER DECK SALOON



LOWER DECK GALLEY



PORT SIDE SINGLE GUEST CABIN

### LOWER DECK AND OPTIONS





PREDATOR 75





## PREDATOR 75

Symmetry and space define the Predator 75. Cohesive indoor and outdoor spaces combined with rich interior details and that ever-recognisable sporty silhouette.







## PRINCIPAL CHARACTERISTICS

LENGTH OVERALL  
23.06 M / 75' 8"

BEAM  
5.38 M / 17' 8"

DRAFT (INC. STERN GEAR)  
FULL LOAD  
1.87 M / 6' 2"

DISPLACEMENT  
46,900 KG / 103,396 LB

FUEL CAPACITY  
4,800 LITRES / 1,268 US GAL.

FRESHWATER CAPACITY  
800 LITRES / 211 US GAL.

BLACK WATER CAPACITY  
200 LITRES / 53 US GAL.

ACCOMMODATION  
UP TO 8 GUESTS AND  
UP TO 2 CREW

ENGINE OPTIONS (TOTAL)  
MAN UP TO 3800PS

MAXIMUM SPEED  
UP TO 40 KNOTS

RANGE @ 21 KNOTS  
UP TO 330 NAUTICAL MILES

DRIVES  
SHAFTS































# PREDATOR 75

## GENERAL ARRANGEMENTS



PROFILE AND EXTERIOR PLAN



## PREDATOR 75 GENERAL ARRANGEMENTS



MAIN AND LOWER DECK





SPORT YACHT





55 SPORT YACHT





## 55 SPORT YACHT

The Sport Yacht concept now in a 55-foot package. The 55 Sport Yacht is an agile performer. Blink, and you might miss it.







## PRINCIPAL CHARACTERISTICS

LENGTH OVERALL  
17.14M / 56' 3"

BEAM  
4.93M / 16' 2"

DRAFT  
1.50 M / 4' 11"

FUEL CAPACITY  
1,800 LITRES / 476 US GAL.

FRESH WATER CAPACITY  
430 LITRES / 114 US GAL.

BLACK WATER CAPACITY  
150 LITRES / 39 US GAL.

ACCOMMODATION  
UP TO 6 GUESTS

ENGINE OPTIONS (TOTAL)  
VOLVO PENTA IPS UP TO 1,450PS

MAXIMUM SPEED  
UP TO 36 KNOTS

DRIVES  
PODS























## 55 SPORT YACHT GENERAL ARRANGEMENTS



### PROFILE

SHOWN WITH OPTIONAL RADAR AND NAVIGATION EQUIPMENT



## 55 SPORT YACHT GENERAL ARRANGEMENTS

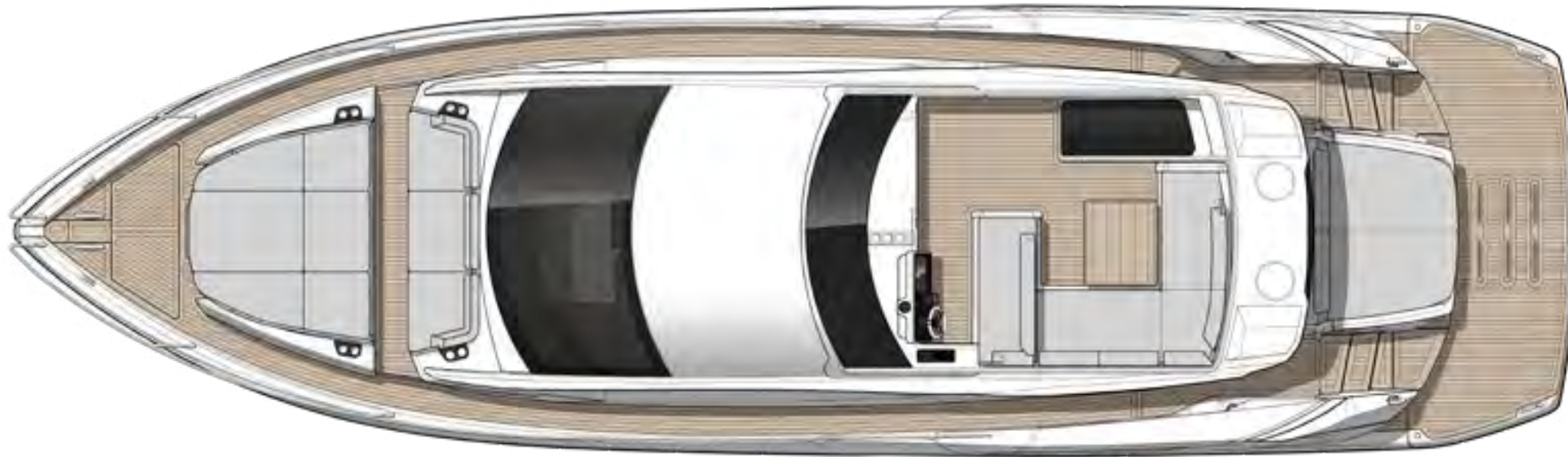

EXTERIOR PLAN  
SHOWN WITH OPTIONAL SIDE DECKING



## 55 SPORT YACHT GENERAL ARRANGEMENTS



MAIN DECK  
SHOWN WITH OPTIONAL SIDE DECKING



## 55 SPORT YACHT GENERAL ARRANGEMENTS



OPTIONAL  
LAUNDRY ROOM



OPTIONAL STARBOARD  
TWIN GUEST CABIN



OPTIONAL MASTER  
STATEROOM  
BREAKFAST SEATING



### LOWER DECK

SHOWN WITH OPTIONAL ADDITIONAL APPLIANCE AND TENDER IN GARAGE





## 65 SPORT YACHT





## 65 SPORT YACHT

The multi-award-winning 65 Sport Yacht is graceful yet modern. With a pulse-quickening 35 knot top speed, helm seating that's pure supercar, generous interior spaces, and best-in-class garage storage, an unforgettable adventure awaits.







## PRINCIPAL CHARACTERISTICS

LENGTH OVERALL  
20.50M / 67' 2"

BEAM  
5.10M / 16' 8"

DRAFT  
1.60 M / 5' 3"

DISPLACEMENT  
37,810 KG / 83,357 LB

FUEL CAPACITY  
3,500 LITRES / 924 US GAL.

FRESH WATER CAPACITY  
800 LITRES / 211 US GAL.

BLACK WATER CAPACITY  
200 LITRES / 52 US GAL.

ACCOMMODATION  
UP TO 7 GUESTS AND  
UP TO 1 CREW

ENGINE OPTIONS (TOTAL)  
VOLVO PENTA IPS UP TO 2,000PS

MAXIMUM SPEED  
UP TO 35 KNOTS

RANGE @ 10 KNOTS  
UP TO 750 NAUTICAL MILES

DRIVES  
PODS































## 65 SPORT YACHT GENERAL ARRANGEMENTS



PROFILE AND FLYBRIDGE



# 65 SPORT YACHT GENERAL ARRANGEMENTS

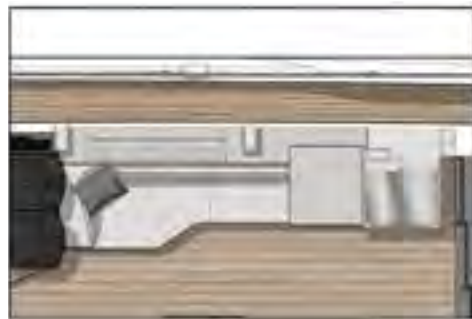

STARBOARD SIDE SOFA WITH RISE  
& FALL TV OUTBOARD.



EXTENDED PORT SIDE SEATING TO SUIT LOWER  
DECK GALLEY ARRANGEMENT.



PORT SIDE COCKPIT WETBAR.

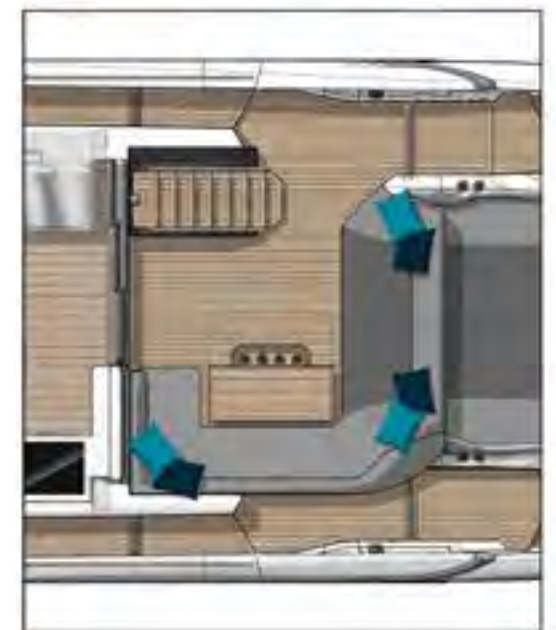

EXTENDED COCKPIT SEATING ARRANGEMENT.

## MAIN DECK AND OPTIONS



## 65 SPORT YACHT GENERAL ARRANGEMENTS



EXTENDED MASTER STATEROOM WITH OFFICE AREA



LOWER DECK SALOON



LOWER DECK GALLEY



PORT SIDE SINGLE GUEST CABIN

### LOWER DECK AND OPTIONS





## 75 SPORT YACHT





## 75 SPORT YACHT

The ultimate driving position awaits on the 75 Sport Yacht. Feel close to the elements on the flybridge or retreat into comfort below decks.







## PRINCIPAL CHARACTERISTICS

LENGTH OVERALL  
23.06M / 75' 8"

BEAM  
5.38M / 17' 8"

DRAFT  
1.87 M / 6' 2"

DISPLACEMENT  
46,900 KG / 103,396 LB

FUEL CAPACITY  
4,800 LITRES / 1,268 US GAL.

FRESH WATER CAPACITY  
800 LITRES / 211 US GAL.

BLACK WATER CAPACITY  
200 LITRES / 53 US GAL.

ACCOMMODATION  
UP TO 8 GUESTS AND  
UP TO 2 CREW

ENGINE OPTIONS (TOTAL)  
MAN UP TO 3,800PS

MAXIMUM SPEED  
UP TO 40 KNOTS

RANGE @ 10 KNOTS  
UP TO 800 NAUTICAL MILES

DRIVES  
SHAFTS































## 75 SPORT YACHT GENERAL ARRANGEMENTS



PROFILE AND FLYBRIDGE



## 75 SPORT YACHT GENERAL ARRANGEMENTS



MAIN AND LOWER DECK



An aerial photograph showing a vast expanse of turquoise water with visible ripples and a sandy beach at the bottom. The word "MANHATTAN" is centered in the water.

MANHATTAN





## MANHATTAN 55





## MANHATTAN 55

Beauty and comfort take their rightful place cruising out at sea, courtesy of the luxurious Manhattan 55. Perfectly proportioned and elegantly designed, its deceptively generous spaces provide endless opportunities to entertain and socialise. With a range of 250 nautical miles and capable of 32 knots at full throttle, this beauty has performance to match.







## PRINCIPAL CHARACTERISTICS

LENGTH OVERALL  
17.21M / 56' 6"

BEAM  
4.87M / 16' 0"

DRAFT  
1.37M / 4' 6"

DISPLACEMENT  
27,000 KG / 59,524 LB

FUEL CAPACITY  
2,200 LITRES / 580 US GAL.

FRESH WATER CAPACITY  
600 LITRES / 158 US GAL.

BLACK WATER CAPACITY  
150 LITRES / 39 US GAL.

ACCOMMODATION  
UP TO 6 GUESTS AND  
UP TO 1 CREW

ENGINE OPTIONS (TOTAL)  
VOLVO PENTA UP TO 1,600PS

MAXIMUM SPEED  
UP TO 32 KNOTS

RANGE @ 21 KNOTS  
UP TO 230 NAUTICAL MILES

DRIVES  
SHAFTS OR PODS































## MANHATTAN 55 GENERAL ARRANGEMENTS



PROFILE AND FLYBRIDGE



## MANHATTAN 55 GENERAL ARRANGEMENTS



MAIN AND LOWER DECK





MANHATTAN 68





## MANHATTAN 68

The Manhattan 68 has one sole purpose. Effortless entertainment. With generous and flexible social spaces, large sunbathing areas, a well-equipped wet bar and a revolutionary aft Beach Club area, the Manhattan 68 is every inch the socialite. Comfort and luxury extend to all four cabins with flexibility across numerous layouts key to this yacht's success.







## PRINCIPAL CHARACTERISTICS

LENGTH OVERALL  
21.21M / 69' 7"

BEAM  
5.26M / 17' 3"

DRAFT  
1.60 M / 5' 4"

DISPLACEMENT  
37,400 KG / 82,453 LB

FUEL CAPACITY  
4,000 LITRES / 1,057 US GAL.

FRESH WATER CAPACITY  
900 LITRES / 238 US GAL.

BLACK WATER CAPACITY  
200 LITRES / 53 US GAL.

ACCOMMODATION  
UP TO 8 GUESTS AND  
UP TO 2 CREW

ENGINE OPTIONS (TOTAL)  
MAN OR VOLVO PENTA IPS UP TO  
2,400PS

MAXIMUM SPEED  
UP TO 32 KNOTS

RANGE @ 10 KNOTS  
UP TO 550 NAUTICAL MILES

DRIVES  
SHAFTS OR PODS













MANHATTAN 68 STANDARD LAYOUT





MANHATTAN 68 PACIFIC LAYOUT









MANHATTAN 68 PACIFIC OPTION







MANHATTAN 68  
GENERAL ARRANGEMENTS



PROFILE AND FLYBRIDGE



OPTIONAL FLYBRIDGE  
ARRANGEMENT WITH  
LOOSE FURNITURE



OPTIONAL FLYBRIDGE  
ARRANGEMENT  
WITH DINING TABLE  
AND 6 CHAIRS



OPTIONAL FLYBRIDGE  
ARRANGEMENT WITH  
FIXED GRP SEATING  
AND TABLE



MANHATTAN 68  
GENERAL ARRANGEMENTS



OPTIONAL FEATURE BAR /  
SNUG IN LIEU  
OF GALLEY



OPTIONAL LOWER  
DECK GALLEY

MAIN AND LOWER DECK  
MANHATTAN 68



MAIN AND LOWER DECK  
MANHATTAN 68 PACIFIC



A full-page background image of a sunset over the ocean. The sun is a bright, glowing orb in the upper center, casting a warm orange and yellow light across the sky. The horizon is visible in the middle ground, with the sun's reflection shimmering on the water's surface. The foreground shows the textured, dark blue-grey waves of the ocean, with some highlights from the low sun. The word "YACHT" is centered in the sky area in a white, sans-serif font.

YACHT





## 76 YACHT





## 76 YACHT

The award-winning 76 Yacht has it all with a host of luxurious entertainment areas complemented by peerless design features. Enjoy panoramic views from the stunning main deck or drive from the flybridge for an unmatched yachting experience.







## PRINCIPAL CHARACTERISTICS

LENGTH OVERALL  
23.60M / 77' 5"

BEAM  
5.95M / 19' 6"

DRAFT  
1.70M / 5' 7"

DISPLACEMENT  
53,700 KG / 118,140 LB

FUEL CAPACITY  
6,000 LITRES / 1,585 US GAL.

FRESH WATER CAPACITY  
1,400 LITRES / 370 US GAL.

BLACK WATER CAPACITY  
400 LITRES / 106 US GAL.

ACCOMMODATION  
UP TO 8 GUESTS AND  
UP TO 3 CREW

ENGINE OPTIONS (TOTAL)  
MAN UP TO 3,100PS

MAXIMUM SPEED  
UP TO 32 KNOTS

RANGE @ 10 KNOTS  
UP TO 500 NAUTICAL MILES

DRIVES  
SHAFTS

















76 YACHT AFT GALLEY LAYOUT











## 76 YACHT GENERAL ARRANGEMENTS



PROFILE AND FLYBRIDGE



76 YACHT  
GENERAL ARRANGEMENTS



STANDARD LAYOUT



AFT GALLEY LAYOUT

MAIN DECK



## 76 YACHT GENERAL ARRANGEMENTS



LOWER DECK





88 YACHT





## 88 YACHT

The award-winning 88 Yacht. A powerful combination of seductive styling with smart practical spaces, incorporating a built-in hardtop, cleverly configured interior and a sumptuous master cabin layout. The Beach Club, complete with an innovative Sunseeker X-TEND™ sunbed to the aft, makes this an icon worthy of your immediate attention.







## PRINCIPAL CHARACTERISTICS

LENGTH OVERALL  
26.38 M / 86' 7"

BEAM  
6.47M / 21' 3"

DRAFT  
2.12M / 7' 0"

DISPLACEMENT  
77,300 KG / 170,417 LB

FUEL CAPACITY  
11,000 LITRES / 2,907 US GAL.

FRESH WATER CAPACITY  
1,400 LITRES / 370 US GAL.

BLACK WATER CAPACITY  
400 LITRES / 106 US GAL.

ACCOMMODATION  
UP TO 8 GUESTS AND  
UP TO 4 CREW

ENGINE OPTIONS (TOTAL)  
MTU UP TO 4,002PS

MAXIMUM SPEED  
UP TO 28 KNOTS

RANGE @ 10/12 KNOTS  
UP TO 1,275 NAUTICAL MILES

DRIVES  
SHAFTS



























## 88 YACHT GENERAL ARRANGEMENTS



PROFILE AND FLYBRIDGE



## 88 YACHT GENERAL ARRANGEMENTS



MAIN DECK OPTION  
SHOWN WITH ALTERNATIVE SALOON  
AND DINING ARRANGEMENT

MAIN DECK AND OPTIONS



## 88 YACHT GENERAL ARRANGEMENTS

LOWER DECK OPTION  
SHOWN WITH OPTIONAL SOFA  
IN MASTER STATEROOM

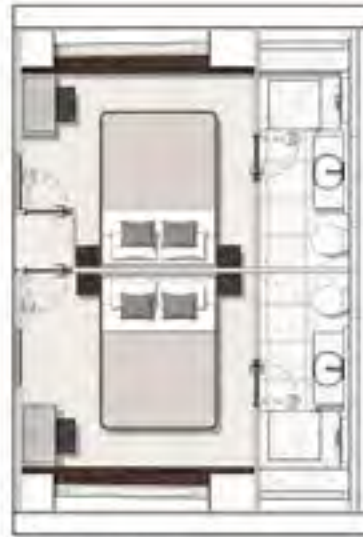

LOWER DECK OPTION  
SHOWN WITH AFT DOUBLE GUEST CABINS  
IN LIEU OF MASTER STATEROOM



LOWER DECK AND OPTIONS





95 YACHT





## 95 YACHT

Perfection touches every corner of the 95 Yacht, a floating oasis dedicated to luxury and craftsmanship. A streamlined exterior teases the eye with a tingling sense of style and beauty that flows uninterrupted into the graceful and spacious interior. From the raised pilothouse and dedicated lower guest cabins to the spectacular triplex master cabin, the 95 Yacht is the epitome of refinement.







## PRINCIPAL CHARACTERISTICS

LENGTH OVERALL  
28.06M / 92' 1"

BEAM  
6.55M / 21' 6"

DRAFT  
2.13 M / 7' 0"

DISPLACEMENT  
84,700 KG / 186,731 LB

FUEL CAPACITY  
12,000 LITRES / 3,170 US GAL.

FRESH WATER CAPACITY  
1,750 LITRES / 462 US GAL.

BLACK WATER CAPACITY  
435 LITRES / 115 US GAL.

GREY WATER CAPACITY  
1,000 LITRES / 264 US GAL.

ACCOMMODATION  
UP TO 10 GUESTS & UP TO 4  
CREW

ENGINE OPTIONS  
MTU UP TO 4,002PS

MAXIMUM SPEED  
UP TO 26.5 KNOTS

RANGE @ 10/12 KNOTS  
UP TO 1,400 NAUTICAL MILES

DRIVES  
SHAFTS































## 95 YACHT GENERAL ARRANGEMENTS



PROFILE AND FLYBRIDGE



## 95 YACHT GENERAL ARRANGEMENTS



MAIN AND LOWER DECK





100 YACHT





## 100 YACHT

A true showpiece, the 100 Yacht is a grand statement of refinement and sophistication. Eloquently expressed through its striking lines, full-beam master cabin, seamless transition from flybridge to foredeck, and fully glazed wheelhouse. Here everything is possible and rules are meant to be broken.







## PRINCIPAL CHARACTERISTICS

LENGTH OVERALL  
29.85M / 97' 11"

BEAM  
6.90M / 22' 8"

DRAFT  
2.10M / 6' 10"

DISPLACEMENT  
99,380 KG / 219,095 LB

FUEL CAPACITY  
12,800 LITRES / 3,381 US GAL.

FRESH WATER CAPACITY  
1,800 LITRES / 476 US GAL.

BLACK WATER CAPACITY  
1,125 LITRES / 297 US GAL.

GREY WATER CAPACITY  
1,125 LITRES / 297 US GAL.

ACCOMMODATION  
UP TO 10 GUESTS AND  
UP TO 5 CREW

ENGINE OPTIONS (TOTAL)  
MTU UP TO 5,280PS

MAXIMUM SPEED  
UP TO 30 KNOTS

RANGE @ 10/12 KNOTS  
UP TO 1,300 NAUTICAL MILES

DRIVES  
SHAFTS























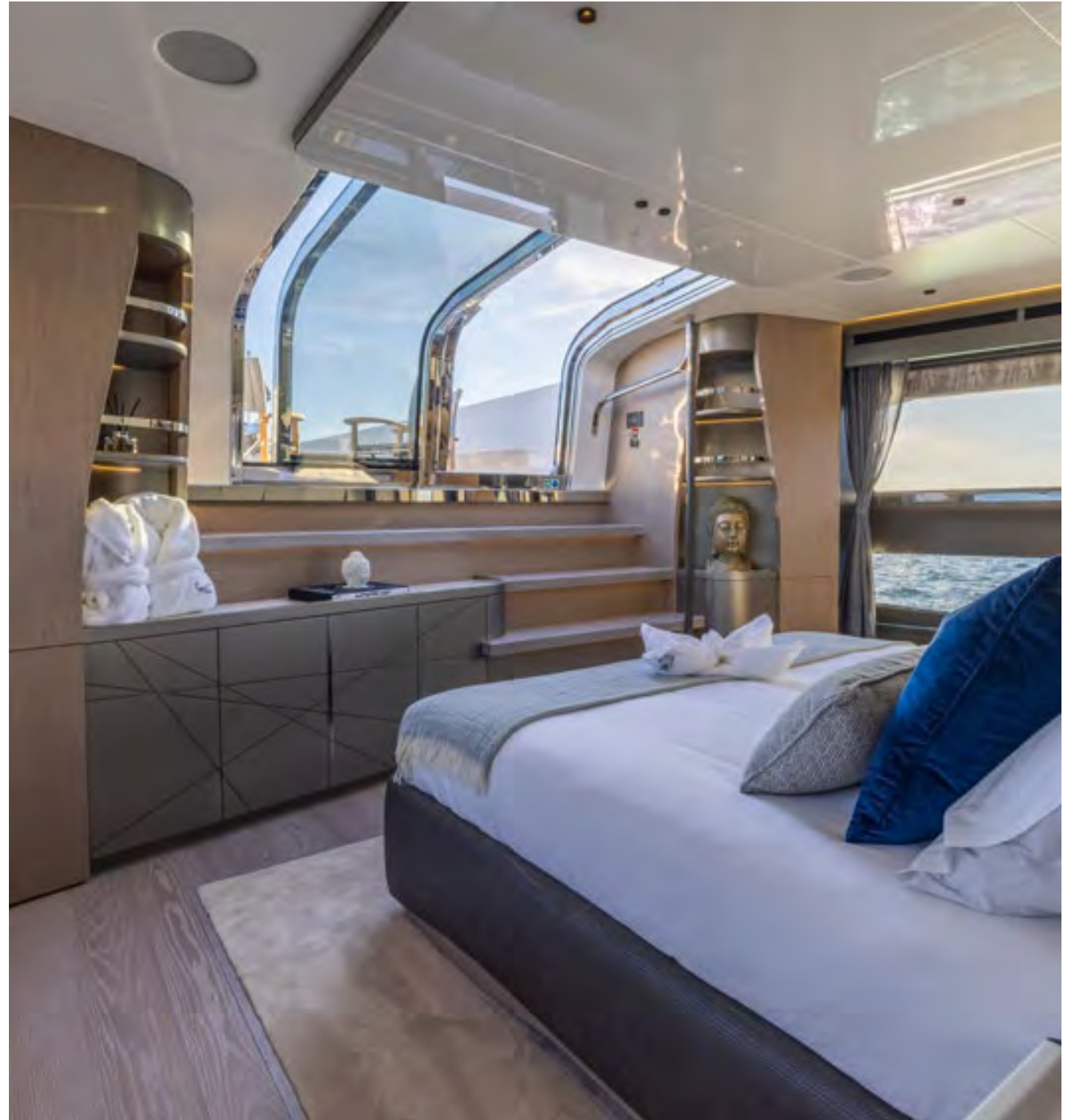







## 100 YACHT GENERAL ARRANGEMENTS

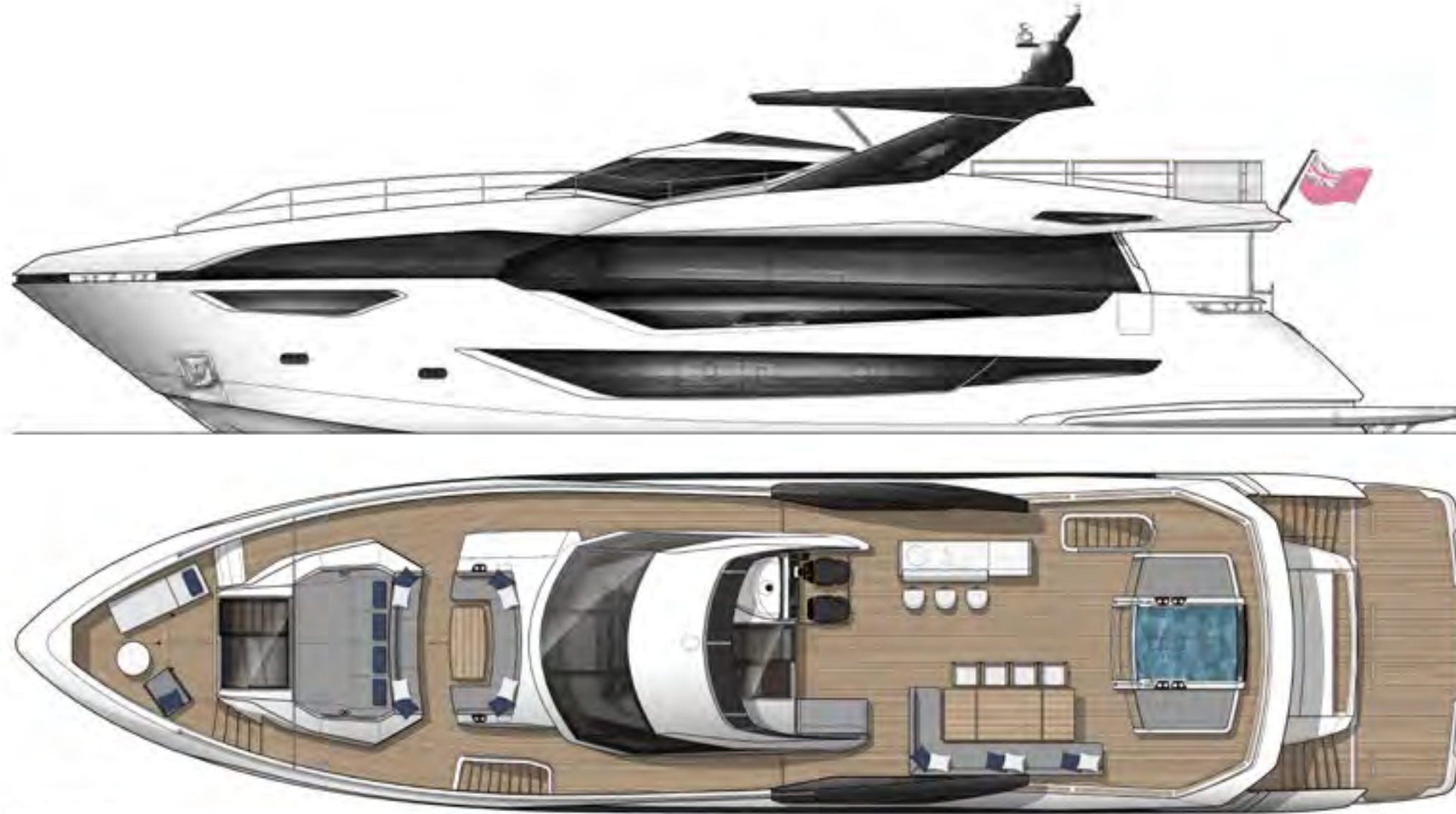

PROFILE AND FLYBRIDGE



# 100 YACHT GENERAL ARRANGEMENTS



MAIN AND LOWER DECK



OCEAN





OCEAN 156





## OCEAN 156

A departure from a typical naming convention, the Ocean 156 is a stunning yacht with exceptional interior volume. Met with ultra-indulgent interior styling, the Ocean 156 is a sanctuary.







## PRINCIPAL CHARACTERISTICS

LENGTH OVERALL  
25.14M / 82' 6"

BEAM  
6.56M / 21' 6"

FUEL CAPACITY  
8,500 LITRES / 2,245 US GAL.

FRESH WATER CAPACITY  
1,500 LITRES / 396 US GAL.

BLACK WATER CAPACITY  
800 LITRES / 211 US GAL.

GREY WATER CAPACITY  
1,250 LITRES / 300 US GAL.

ENGINES OPTIONS (TOTAL)  
MAN UP TO 3,300PS

RANGE @ 10/12 KNOTS  
UP TO 900 NAUTICAL MILES

DRIVES  
SHAFTS







































# OCEAN 156

## GENERAL ARRANGEMENTS



### PROFILE

SHOWN WITH OPTIONAL SATELLITE DOMES AND TWIN ANCHOR ARRANGEMENT



## OCEAN 156

### GENERAL ARRANGEMENTS

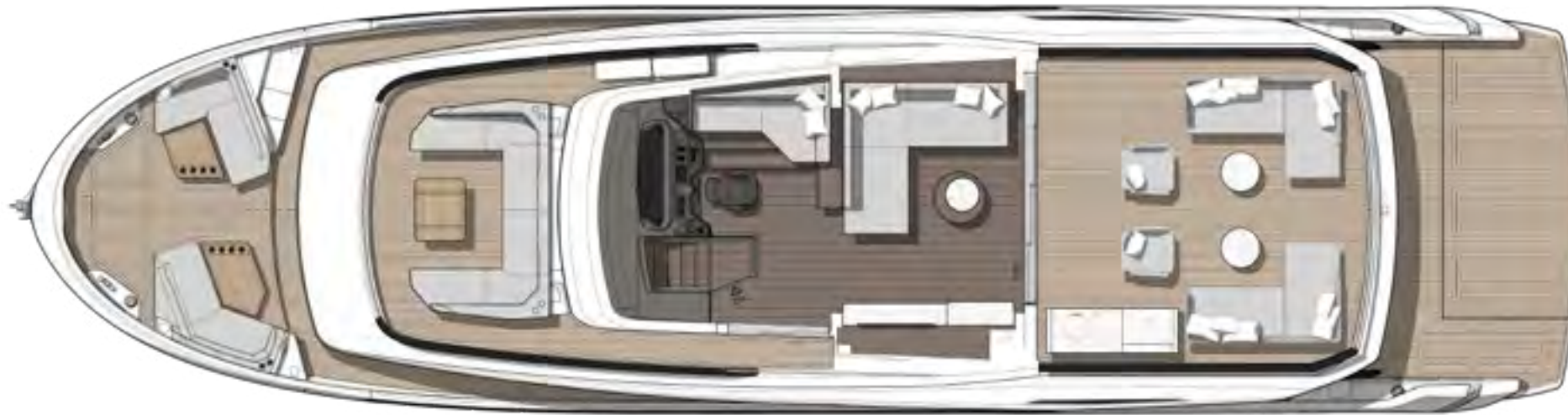

#### UPPER DECK

SHOWN WITH OPTIONAL FORWARD DECKING, LIFERAFTS, INTERIOR WOODEN FLOORING,  
UPPER DECK COCKPIT DECKING AND LOOSE SEATING ARRANGEMENT



# OCEAN 156

## GENERAL ARRANGEMENTS

STANDARD LAYOUT



OPTION B  
MID GALLEY WITH  
FORWARD DINING  
AND AFT SALOON



### MAIN DECK OPTIONS

SHOWN WITH OPTIONAL TWIN ANCHOR ARRANGEMENT, SIDE DECK AND FOREDECK DECKING, FORWARD PATIO DOOR, GALLEY SIDE DOOR, DAYHEAD AND SUNSEEKER X-TEND™ TRANSFORMER SUNBEAD ARRANGEMENT WITH LOOSE COCKPIT FURNITURE



## OCEAN 156 GENERAL ARRANGEMENTS

OPTION C  
MID GALLEY WITH  
FORWARD SALOON  
AND AFT DINING



OPTION D  
MAIN DECK  
STATEROOM WITH  
MID GALLEY AND  
AFT SALOON



### MAIN DECK OPTIONS

SHOWN WITH OPTIONAL TWIN ANCHOR ARRANGEMENT, SIDE DECK AND FOREDECK DECKING, FORWARD PATIO DOOR, GALLEY SIDE DOOR, DAYHEAD AND SUNSEEKER X-TEND™ TRANSFORMER SUNBEAD ARRANGEMENT WITH LOOSE COCKPIT FURNITURE



# OCEAN 156

## GENERAL ARRANGEMENTS



LOWER DECK





90 OCEAN





## 90 OCEAN

The award-winning 90 Ocean will surprise and delight owners and guests alike. Every carefully considered detail elevates its sense of superiority beyond all expectations courtesy of wide open-plan spaces which evoke an impressive penthouse-style. A stem bow and broad beam immediately signal its ambitious intentions with a vast flybridge and an enhanced new Beach Club complete with Sunseeker X-TEND™ seating, bringing guests closer to the water than ever before.







## PRINCIPAL CHARACTERISTICS

LENGTH OVERALL  
27.10M / 88' 11"

BEAM  
7.16M / 23' 6"

DRAFT  
1.94 M / 6' 4"

DISPLACEMENT  
82,300 KG / 181,440 LB

FUEL CAPACITY  
13,000 LITRES / 3,434 US GAL.

FRESH WATER CAPACITY  
1,500 LITRES / 400 US GAL.

BLACK WATER CAPACITY  
800 LITRES / 211 US GAL.

GREY WATER CAPACITY  
1,250 LITRES / 300 US GAL.

ACCOMMODATION  
UP TO 10 GUESTS AND  
UP TO 4 CREW

ENGINE OPTIONS (TOTAL)  
MAN UP TO 3,800PS

MAXIMUM SPEED  
UP TO 27 KNOTS

RANGE @ 10/12 KNOTS  
UP TO 1,900 NAUTICAL MILES

DRIVES  
SHAFTS



























## 90 OCEAN GENERAL ARRANGEMENTS

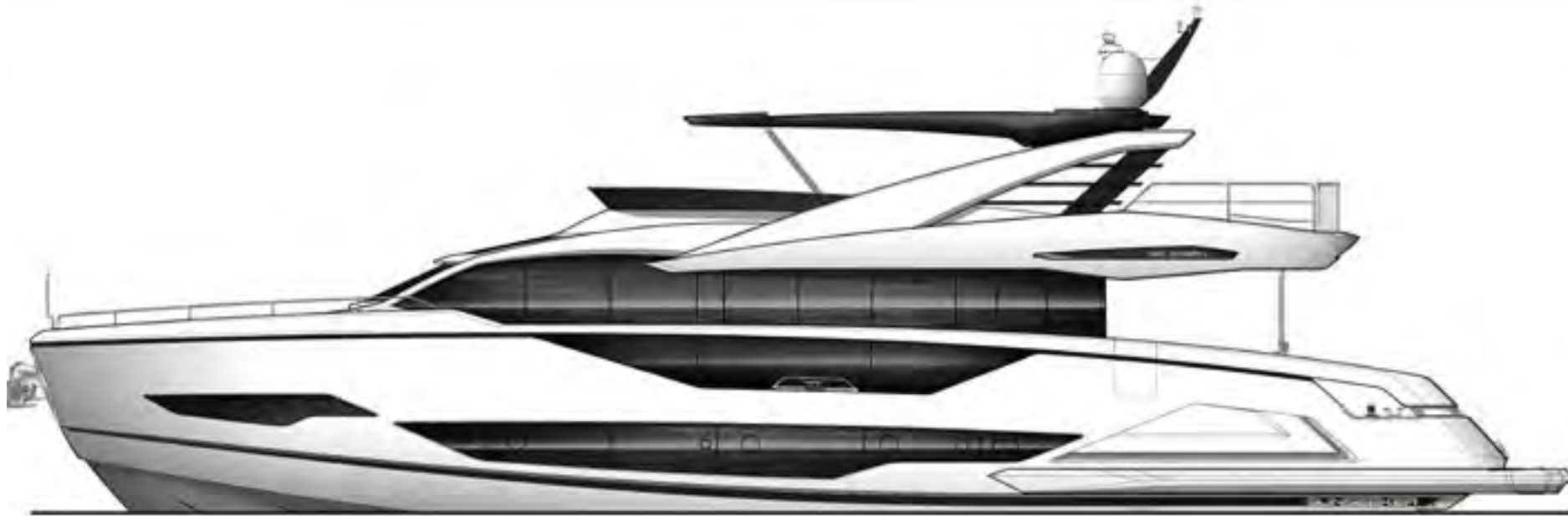

PROFILE AND FLYBRIDGE



## 90 OCEAN GENERAL ARRANGEMENTS



MAIN DECK AND OPTION



MAIN DECK SALOON  
SHOWN WITH EXTENDED SOFA SEATING, GALLEY  
BAR WITH STOOLS AND PORT SIDE DINING



## 90 OCEAN GENERAL ARRANGEMENTS



LOWER DECK





OCEAN 182





## OCEAN 182

Majestic and practical, the Ocean 182 promises the very best in comfort for long-distance cruising and efficient performance. Social zones open to the elements and expansive inside spaces offer the best of both worlds.







## PRINCIPAL CHARACTERISTICS

LENGTH OVERALL  
27.10M / 88' 11"

BEAM  
7.16M / 23' 6"

DRAFT  
1.95 M / 6' 5"

DISPLACEMENT  
82,300 KG / 181,440 LB

FUEL CAPACITY  
13,000 LITRES / 3,434 US GAL.

FRESH WATER CAPACITY  
1,500 LITRES / 400 US GAL.

BLACK WATER CAPACITY  
800 LITRES / 211 US GAL.

GREY WATER CAPACITY  
1,250 LITRES / 300 US GAL.

ACCOMMODATION  
UP TO 10 GUESTS AND  
UP TO 4 CREW

ENGINE OPTIONS (TOTAL)  
MAN UP TO 3,800PS

MAXIMUM SPEED  
27 KNOTS

RANGE @ 10/12 KNOTS  
UP TO 1,100 NAUTICAL MILES

DRIVES  
SHAFTS























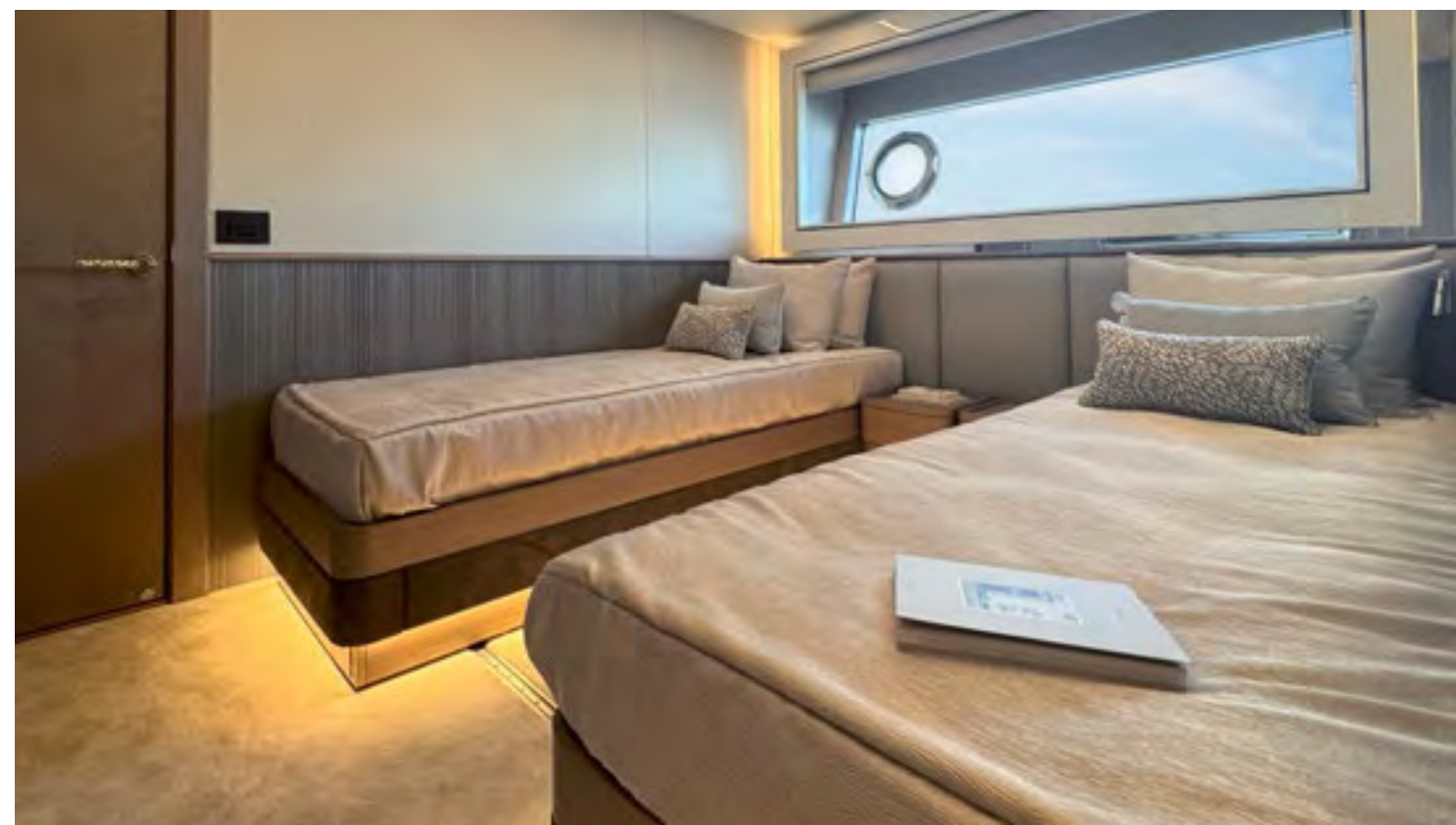



# OCEAN 182

## GENERAL ARRANGEMENTS



PROFILE  
SHOWN WITH OPTIONAL SATELLITE DOMES



## OCEAN 182

### GENERAL ARRANGEMENTS



UPPER DECK



## OCEAN 182

### GENERAL ARRANGEMENTS



#### UPPER DECK OPTION

SHOWN WITH OPTIONAL DINING ARRANGEMENT AND AFT SEATING ARRANGEMENT



# OCEAN 182

## GENERAL ARRANGEMENTS

SHOWN WITH  
OPTIONAL  
X-TEND SUNBED  
TRANSFORMER  
WITH LOOSE  
COCKPIT FURNITURE,  
MAIN DECK DAYHEAD  
AND WOODEN  
FLOORING



SHOWN WITH  
OPTIONAL PORT  
DOUBLE GUEST CABIN  
AND SLIDING BEDS IN  
STBD GUEST CABIN



MAIN AND LOWER DECK





OCEAN 460





## OCEAN 460

A captivating presence. The Ocean 460 redefines what it means to own a superyacht. An art form on the water, each zone has been considered to the finest detail. A private oasis awaits.







## PRINCIPAL CHARACTERISTICS

LENGTH OVERALL  
42.0M / 137' 10"

BEAM  
9.50M / 31' 0"

DRAFT  
2.70 M / 8' 10"

DISPLACEMENT @ HALF LOAD  
220,000 KG / 485,017 LB

FUEL CAPACITY (STANDARD)  
24,600 LITRES / 6,499 US GAL.

TOTAL LONG RANGE CAPACITY  
(WITH OPTIONAL TANK)  
30,000 LITRES / 7,926 US GAL.

FRESH WATER CAPACITY  
6,500 LITRES / 1,717 US GAL.

BLACK WATER CAPACITY  
2,000 LITRES / 528 US GAL.

GREY WATER CAPACITY  
2,500 LITRES / 660 US GAL.

ACCOMMODATION  
UP TO 12 GUESTS & UP TO 9 CREW

ENGINE OPTIONS  
MTU UP TO 5,280 PS

MAXIMUM SPEED  
UP TO 21 KNOTS

RANGE @ 10-12 KNOTS  
UP TO 3,200 NAUTICAL MILES

DRIVES  
SHAFTS

GROSS TONNAGE  
460GT



















# OCEAN 460

## GENERAL ARRANGEMENTS



PROFILE



# OCEAN 460

## GENERAL ARRANGEMENTS

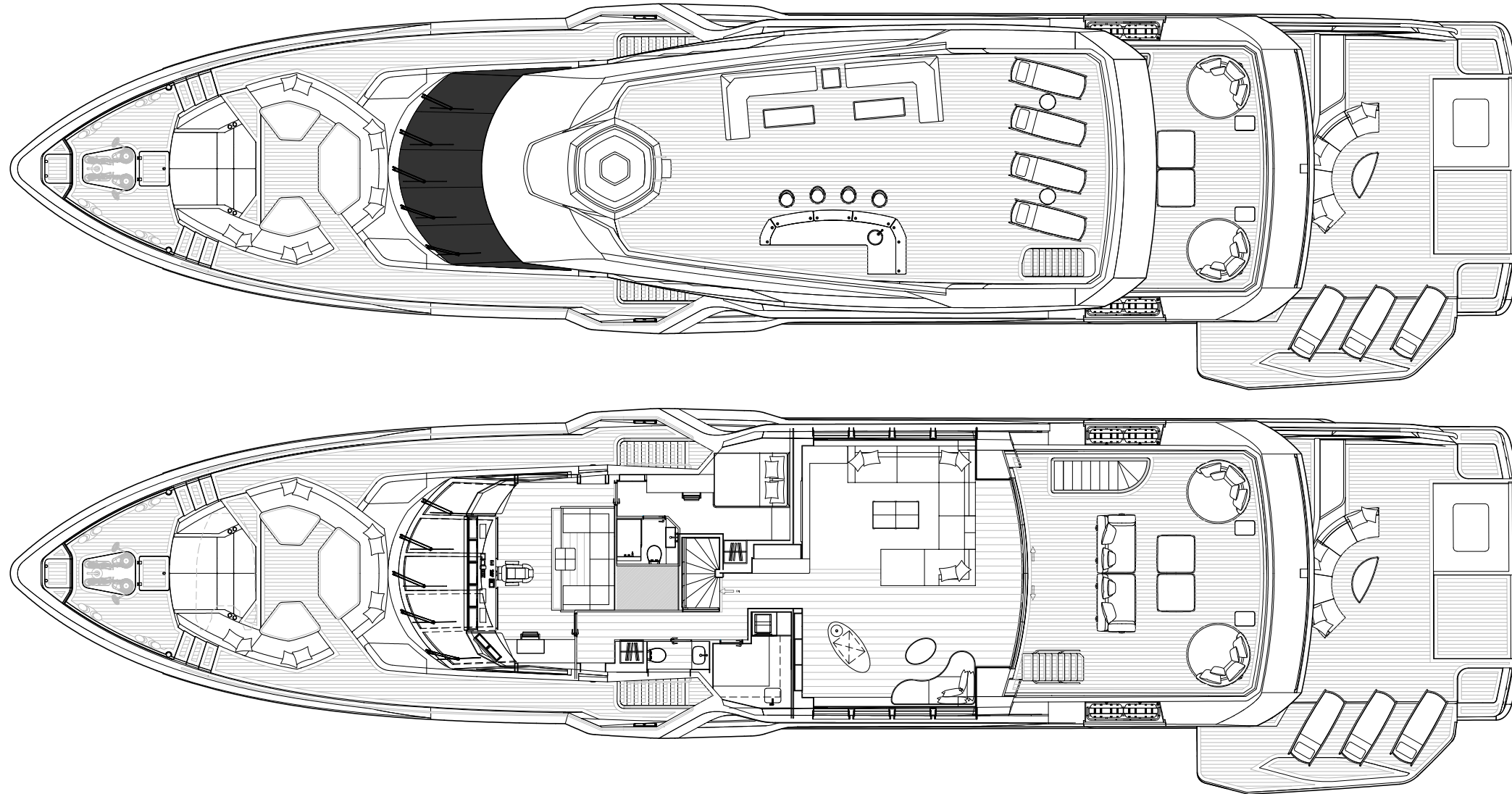

SKY AND UPPER DECK



# OCEAN 460

## GENERAL ARRANGEMENTS

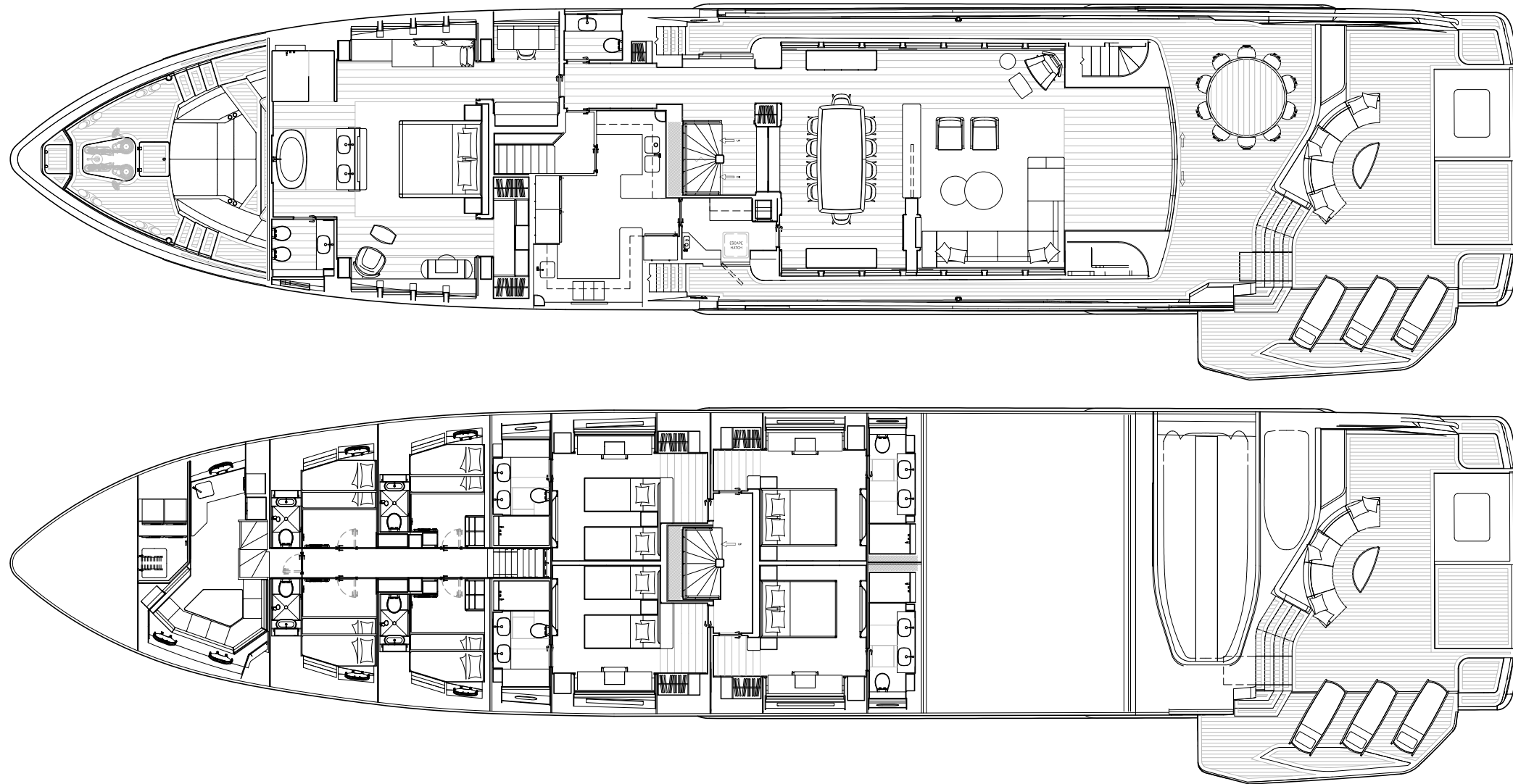

MAIN AND LOWER DECK



The image is a full-page background featuring a close-up, high-contrast view of water. The water's surface is covered in intricate, swirling patterns of light and dark blue, creating a textured, almost abstract appearance. The lighting is bright, causing some areas to appear almost white, while others are deep navy blue. Centered horizontally and vertically over this background is the word "SUPERYACHT" in a clean, white, sans-serif typeface. The letters are widely spaced, giving the text a modern and minimalist feel.

SUPERYACHT





116 YACHT





## 116 YACHT

The 116 Yacht epitomises style and sophistication. Built for luxurious entertaining, whether it's the dedicated living and dining areas, enlarged foredeck, spacious flybridge framed by dramatic floor-to-ceiling windows, the full-beam master cabin or bespoke spa bath configuration. The 116 Yacht delivers the ultimate owner experience.







## PRINCIPAL CHARACTERISTICS

LENGTH OVERALL  
35.20M / 115' 6"

BEAM  
7.33M / 24' 0"

DRAFT  
2.44 M / 8' 0"

DISPLACEMENT  
140,000 KG / 308,000 LB

FUEL CAPACITY (STANDARD)  
14,450 LITRES / 3,817 US GAL.

TOTAL LONG RANGE CAPACITY  
(WITH OPTIONAL TANK)  
19,400 LITRES / 5,124 US GAL.

FRESH WATER CAPACITY  
4,000 LITRES / 1,055 US GAL.

BLACK WATER CAPACITY  
1,340 LITRES / 355 US GAL.

GREY WATER CAPACITY  
1,225 LITRES / 330 US GAL.

ACCOMMODATION  
UP TO 12 GUESTS & UP TO 5 CREW

ENGINE OPTIONS  
MTU UP TO 5,280 PS

MAXIMUM SPEED  
UP TO 26 KNOTS

RANGE @ 12 KNOTS  
UP TO 1,500 NAUTICAL MILES

DRIVES  
SHAFTS

GROSS TONNAGE  
220GT



























# 116 YACHT GENERAL ARRANGEMENTS



PROFILE



116 YACHT  
GENERAL ARRANGEMENTS

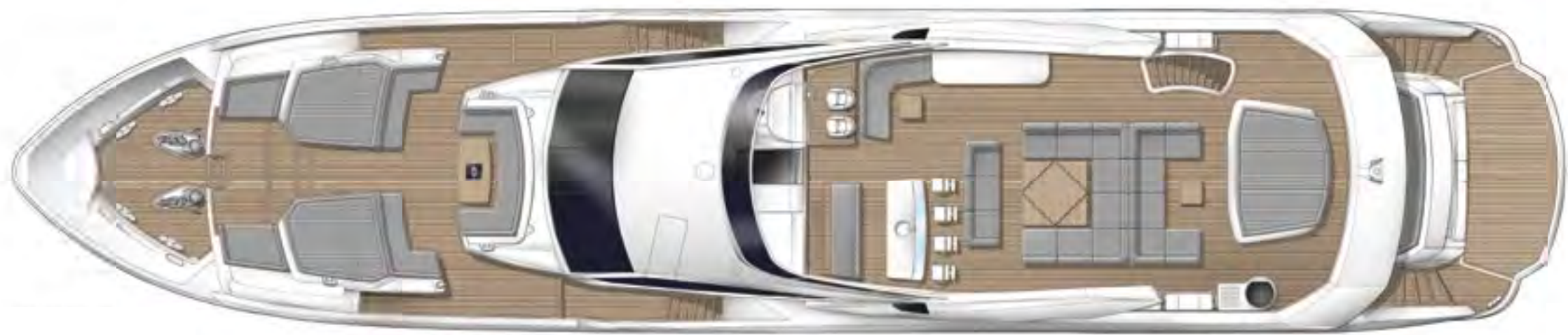

FOREDECK OPTION  
SHOWN WITH  
SPA TUB



WHEELHOUSE



FLYBRIDGE OPTION  
SHOWN WITH SPA TUB AND  
SUNPAD ARRANGEMENT

FLYBRIDGE AND OPTIONS



## 116 YACHT GENERAL ARRANGEMENTS



MAIN AND LOWER DECK





120 YACHT





## 120 YACHT

Make your presence felt effortlessly. Break boundaries with grace. Be poised. Make a sophisticated statement. Wherever you are, find tranquillity.







## PRINCIPAL CHARACTERISTICS

LENGTH OVERALL  
36.6 M / 120' 0"

BEAM  
7.3 M / 24' 1"

DRAFT  
2.50 M / 8' 3"

DISPLACEMENT  
142,000 KG / 313,056 LB

FUEL CAPACITY  
19,500 LITRES / 5,151 US GAL.

FRESH WATER CAPACITY  
4,400 LITRES / 1,162 US GAL.

BLACK WATER CAPACITY  
1,340 LITRES / 354 US GAL.

GREY WATER CAPACITY  
1,255 LITRES / 332 US GAL.

ACCOMMODATION  
UP TO 10 GUESTS AND  
UP TO 5 CREW

ENGINE OPTIONS  
2X MTU 12V 2000

MAXIMUM SPEED  
UP TO 20 KNOTS

RANGE @ 10 KNOTS  
UP TO 1,730 NAUTICAL MILES

DRIVES  
SHAFTS































# 120 YACHT GENERAL ARRANGEMENTS



PROFILE



## 120 YACHT GENERAL ARRANGEMENTS

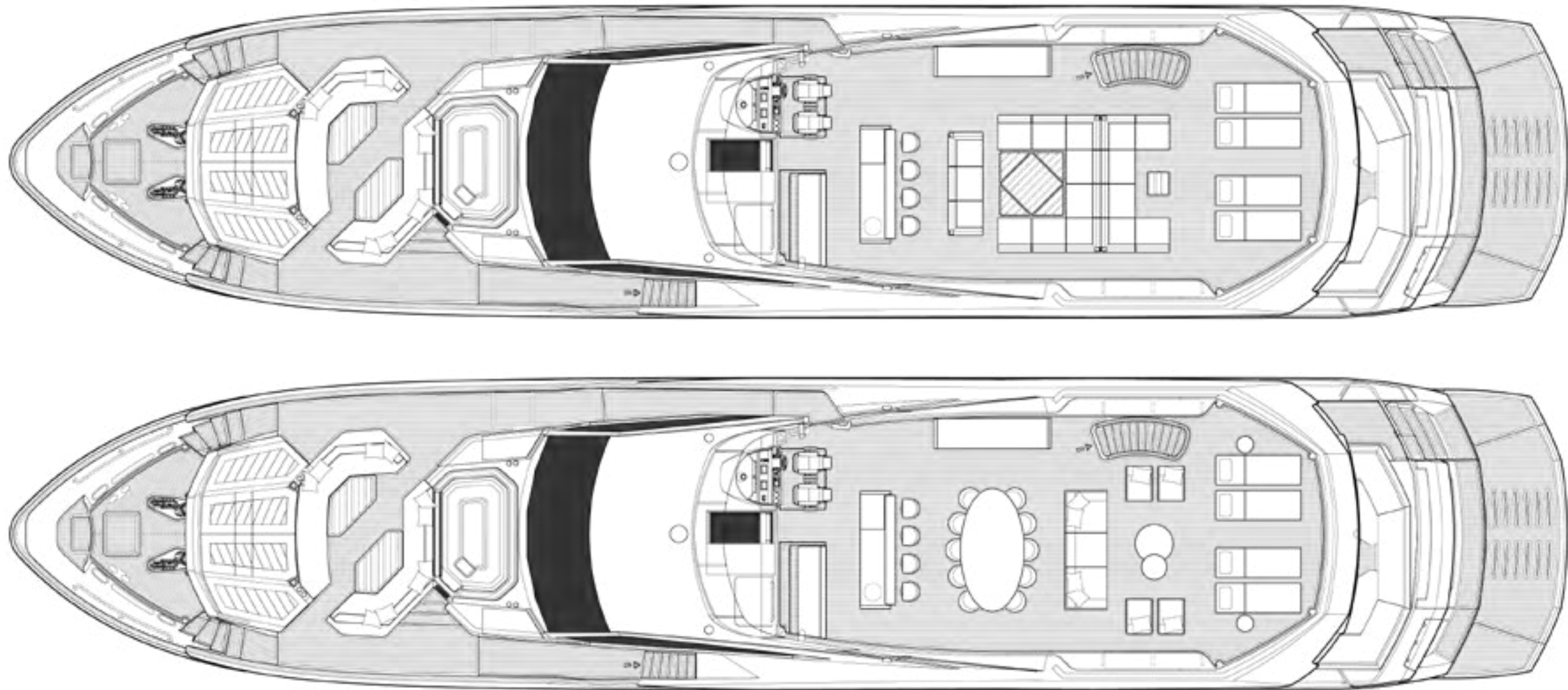

FLYBRIDGE AND FLYBRIDGE OPTION



# 120 YACHT GENERAL ARRANGEMENTS

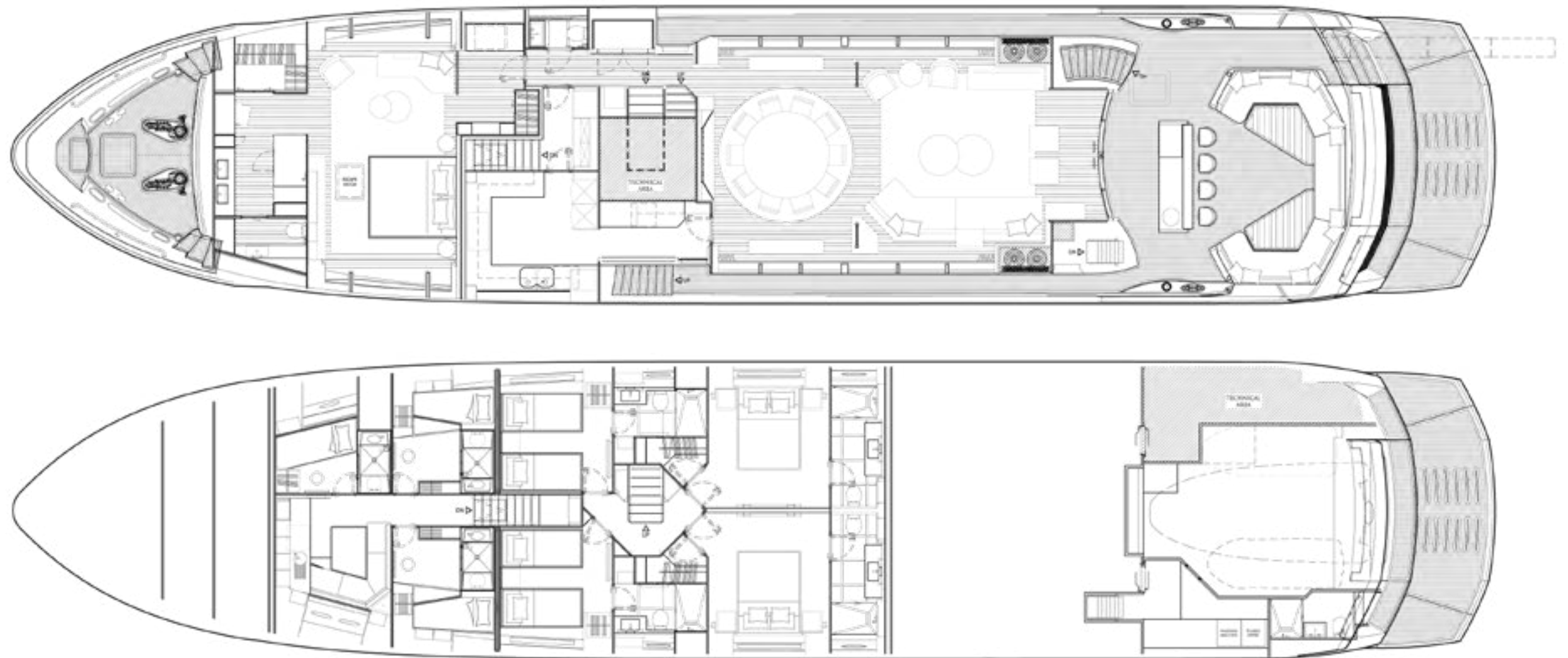

MAIN AND LOWER DECK





131 YACHT





## 131 YACHT

The tri-deck 131 Yacht has a unique exterior profile and stunning interior space, it's one of the finest examples of modern-day superyacht design and craftsmanship. With seemingly endless layout options and opportunities to personalise at almost every turn, the opulent 131 Yacht is your very own private island.







## PRINCIPAL CHARACTERISTICS

LENGTH OVERALL  
40.05M / 131' 5"

BEAM  
8.09M / 26' 7"

DRAFT  
2.85 M / 9' 4"

DISPLACEMENT  
189,600 KG / 417,996 LB

FUEL CAPACITY (STANDARD)  
21,650 LITRES / 5,715 US GAL.

TOTAL LONG RANGE CAPACITY  
(WITH OPTIONAL TANK)  
26,700 LITRES / 7,050 US GAL.

FRESH WATER CAPACITY  
4,950 LITRES / 1,307 US GAL.

BLACK WATER CAPACITY  
1,450 LITRES / 383 US GAL.

GREY WATER CAPACITY  
1,350 LITRES / 356 US GAL.

ACCOMMODATION  
UP TO 12 GUESTS & UP TO 9 CREW

ENGINE OPTIONS  
MTU UP TO 6,362 PS

MAXIMUM SPEED  
UP TO 25 KNOTS

RANGE @ 12 KNOTS  
UP TO 1,600 NAUTICAL MILES

DRIVES  
SHAFTS



























# 131 YACHT GENERAL ARRANGEMENTS



PROFILE



# 131 YACHT GENERAL ARRANGEMENTS



SKY AND UPPER DECK



# 131 YACHT GENERAL ARRANGEMENTS



MAIN AND LOWER DECK





Whilst every effort has been made to provide accurate information, the content of this e-brochure is not intended to be, and should not be relied upon as providing, any warranty, representation, guarantee, or offer. Performance and range figures are estimates to be used as an indicative guide only and are not guaranteed. Dirt or marine growth on the hull, size of boat, engine choice and tuning, propeller condition and pitch, air and water temperature, fuel weight and quality, water weight, stores, number of people on board and other factors can each affect a boat's performance and range. The photographs and artist's impressions in this e-brochure are from existing models in the Sunseeker range. There may be items shown in these photographs and impressions that are not included in the standard inventory of the models shown. Specifications, measurements and certain other details contained in this e-brochure may relate to models only for sale in a particular territory. We cannot guarantee that the entire Sunseeker range will be available in every territory. Specifications for models sold in different territories may also vary. Specifications may be changed or models withdrawn at any time without prior notice. The individual specification for each vessel will be agreed as part of the order process and confirmed in the sales contract between the purchaser and the approved Sunseeker distributor or dealer in the relevant territory. Please contact the local Sunseeker distributor or dealer in the territory which is of interest to you, to enquire as to the models and options that are likely to be available in that territory. This e-brochure is created and published in the United Kingdom by or on behalf of Sunseeker International Ltd and subject to the limitations and exclusions set out herein provides information relating to new Sunseeker™ manufactured motor yachts sold outside of the United States of America and Canada. For parties requiring information on new Sunseeker models for sale in the United States or Canada please contact a Sunseeker USA Sales Co. Inc. appointed dealer in the relevant territory. All distributors and dealers of new Sunseeker manufactured motor yachts are independently owned and controlled businesses. They are not subsidiaries of, or agents for, Sunseeker International Limited, Sunseeker USA Sales Co. Inc. or any of their respective parent, subsidiary or affiliated companies. As such, no distributor or dealer has any authority to bind or obligate any Sunseeker company in any way unless first agreed in writing signed by an authorized Sunseeker signatory.

Information about how we use personal data is set out in our Privacy Policy at <https://www.sunseeker.com/legal>